

# 10a

## Farmers Market

Concept for a farmers market at the gateway to downtown at US 441 and Jefferson Street. This would welcome tourists downtown and encourage more use of the existing Railroad Park.

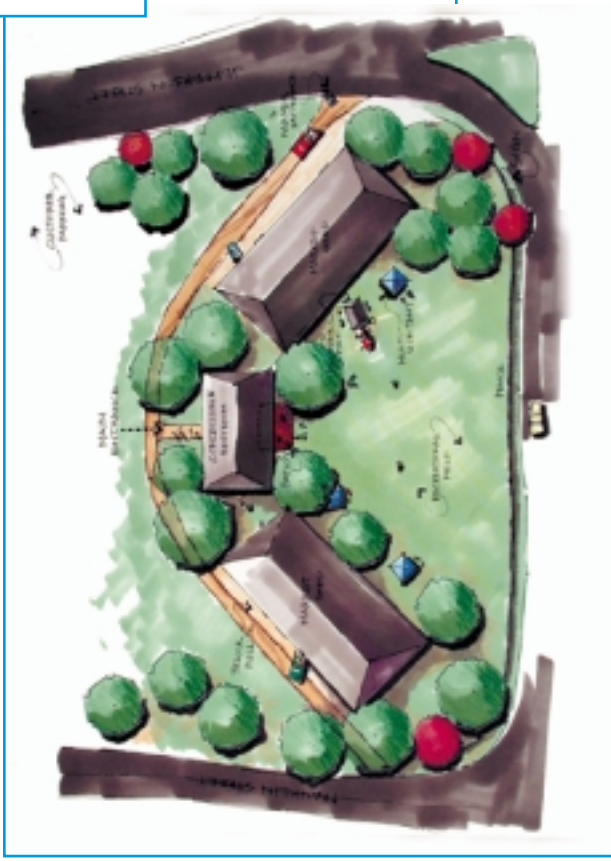

# 10b

## Farmers Market

Interim use of proposed farmers market site until market buildings are constructed.



## 11

### Neighborhood Commercial Centers

Potential neighborhood commercial centers for intown Dublin neighborhoods. Circles represent a five minute walking radius. Existing or new infill commercial buildings at the center of each circle could form a neighborhood activity center (small shops, community facilities, etc.) for each pedestrian-oriented neighborhood.

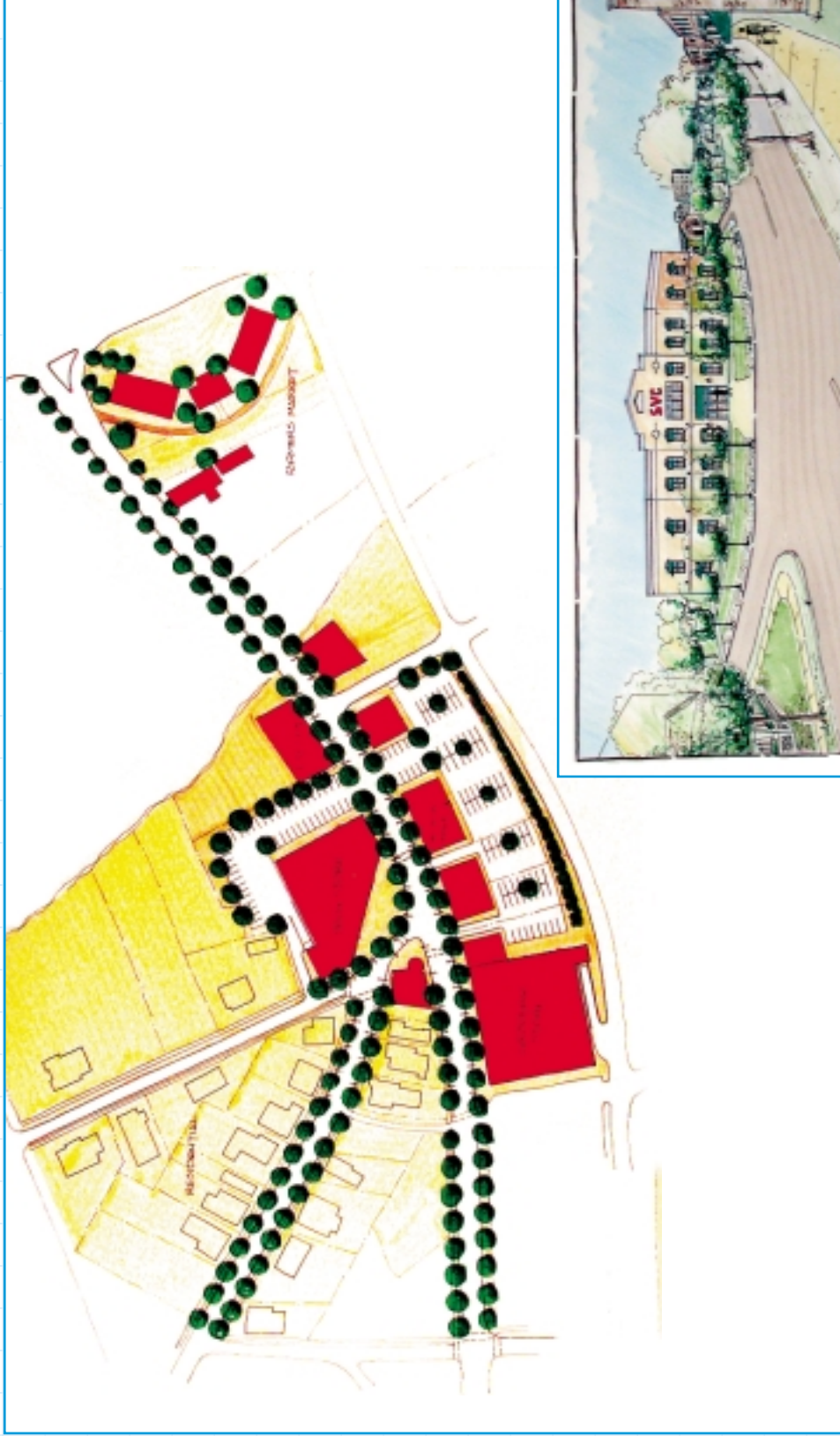

### Southside Neighborhood Concept

Detailed concept for a neighborhood activity center to serve the Southside neighborhood, utilizing existing historic commercial buildings and compatible new infill construction.

12

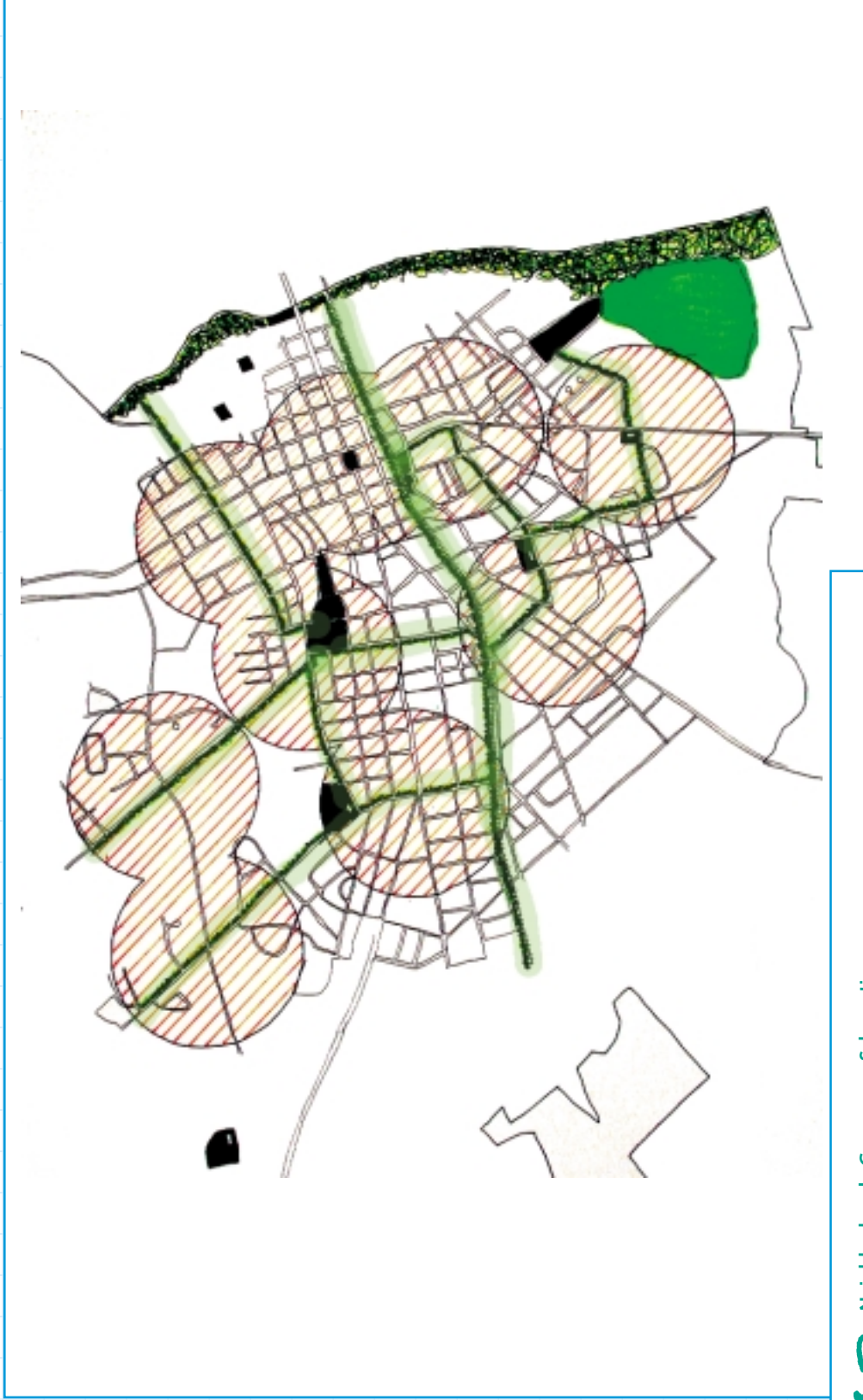

# 13

## Neighborhoods Greenways Schematic

Schematic for linking intown neighborhood activity centers with a network of bicycle/pedestrian greenways (highlighted with green).

BEFORE

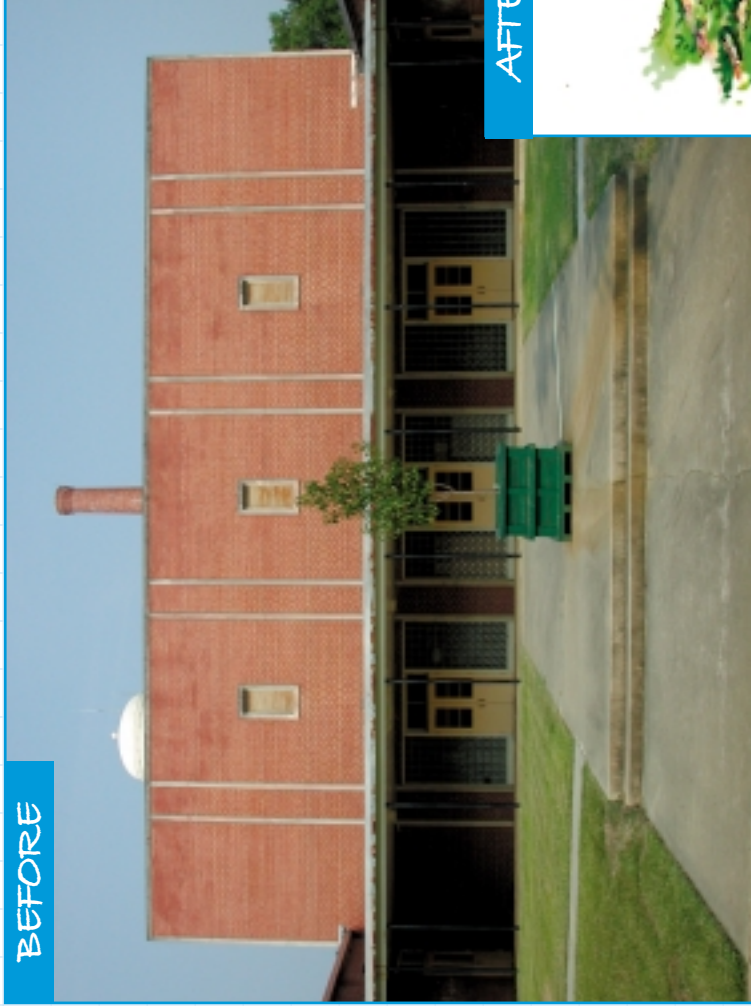

AFTER



## 14

### Concept for Middle School Redevelopment

Concept for recycling the Dublin Middle School as mixed-income loft apartments or condominiums. Existing gymnasium could be adapted as a health facility to serve the complex.